

Using method

Hold the steering wheels by hands after sitting on the swing car, turn on the left or right to move forward, the body sways left and right with swing car, the maximum is 2.8 meters per second.

Playing place

This swing car is used to play in living rooms, park, residential areas, kindergarden or any flat surface

Functions

This swing car works on centrifugal force principle and principle of inertia of human body. It does not need batteries, fuel energy or moving device to move.

Material structure

This swing car is made of high quality PP plastic and steel, bearings etc.

Maximum weight

50 kg on a flat place

Maintenance

Strong hit is not allowed when using this swing car please use in a flat surface to avoid the wheels get worn out, please keep it indoor and clean it after using.

Cautions

Skill is required to avoid falls or collisions causing injury to user or third parties, protective equipment should be worn(helmet, gloves, knee guard, elbow guard...)protective equipment.

This manual contains important information, please keep it always.

Production and contact information

Item: swing car

Model: LB1802

Size: 690X308X369

Suitable age: 3 years and above



Swing Car Instruction manual



① Installation photos

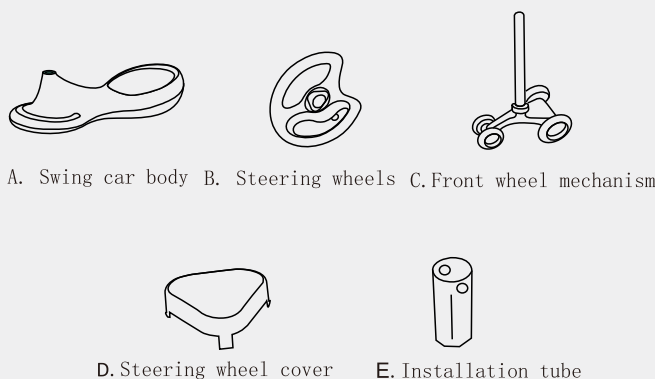
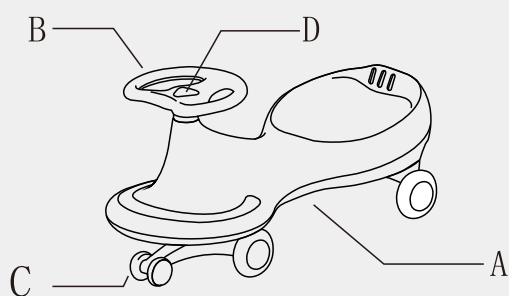

Warning

- Adult installation is required.
- This swing contains small parts, it's not suitable for children who are under 3 years old.
- Adult's supervision is required during play, motor roads or bad road condition are prohibited.
- Please make sure to sit on the seat properly and avoid leaning.

② Steps of installation

1. As shown in picture, open the package, take out all parts of the swing car in order, please check if any parts are missed.

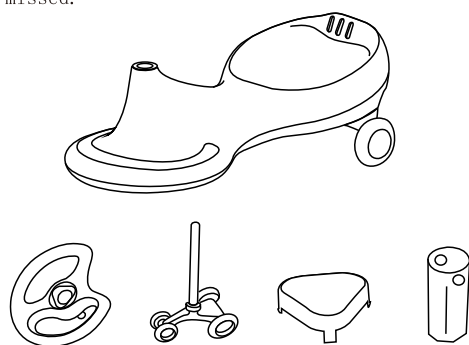

2. As shown in picture, turn over swing car body, insert the steel pipe into the hole of the bottom of swing car body.

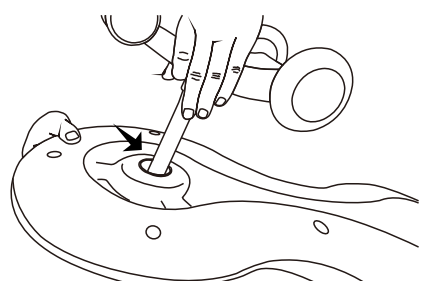

1

3. As shown in picture, knock at the bottom of the front wheel mechanism by a rubber hammer, make the bearing of the front wheel mechanism insert into the hole of the swing car body totally.

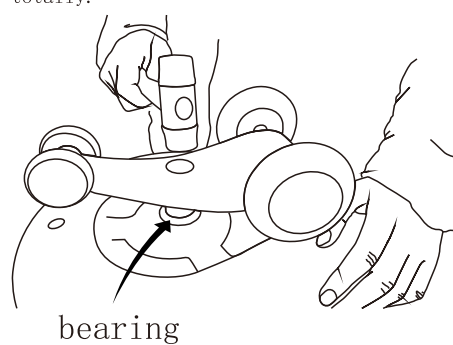

4. Take out the steering wheel, check if the expansion is loose, put PP bearing into the hold of the body.

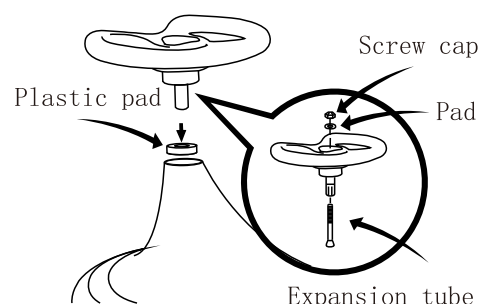

2

5. As shown in picture, adjust the steering wheel and make the lacked shape forward.

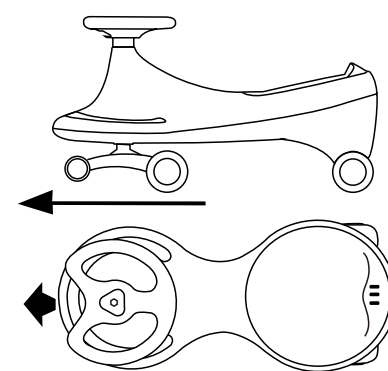

6. Take out the installation tube, use a screw driver to insert it into the hole of the installation tube, use proper power to make the expansion screw tight and make the steering wheels fixed, cap the hole, installation is finished.

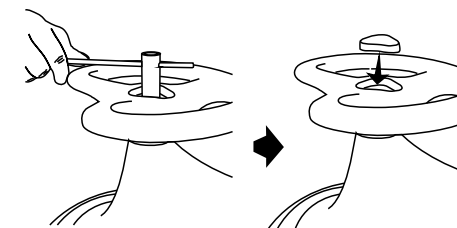

3