

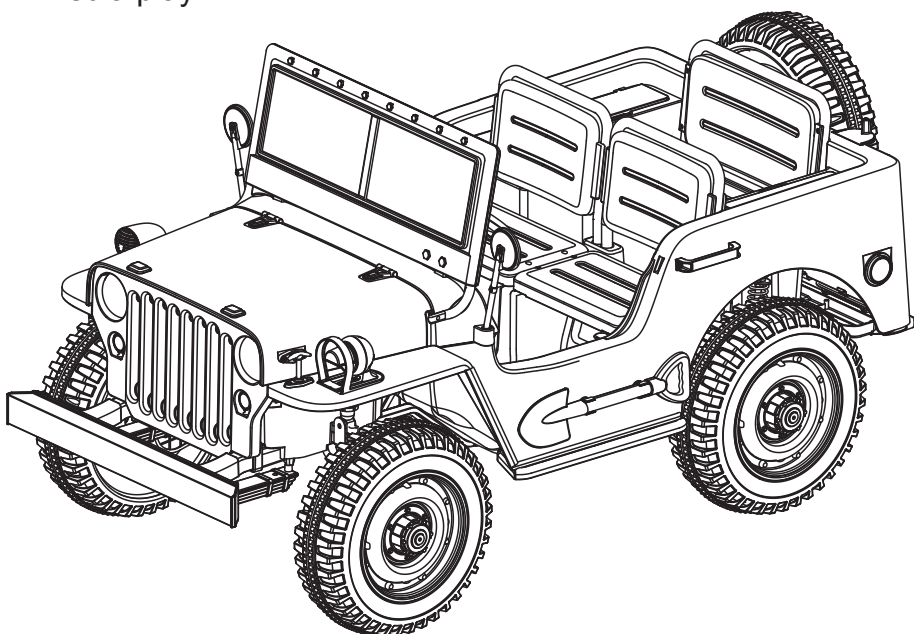

## Military Willy Jeep

FR9779/DM-101 24V

- fast/slow selection
- multifunctional remote control
- 2.4G slow boot
- media play



Instruction for installation and use of DM-101 baby carrier

Instructions to be read before use

Remember to keep the instruction for further reference



Please read this instruction carefully before start using this product. It will tell you details which refer to installing steps and right way to use it. It will also teach you how to avoid operation mistakes so that you won't break this product and harm the rider. Please keep it appropriately and put it in the place where you can acquire easily.

specification	Dual-wheel	Four-wheel drive
Storage	24V7Ah x1	24V7Ah x1
Drive motor	RS550-24VX2	RS550-24VX4
Steering motor	RS390SP-24VX1	RS390SP-24VX1
Charger	24V750mA	24V750mA
Load limit	60KGS/132.3LBS	60KGS/132.3LBS
Using time	1-2hours after charging	1-2hours after charging
Speed	3-3.5KM/H & 1.9-2.2MP/H	3.5-4KM/H & 2.2-2.5MP/H
Age limit	37-95months	37-95months
Remote distance/ remote battery	15±5M/ AAA1.5V*2	15±5M/ AAA1.5V*2
Body size	162X81X82CM/63.8X31.9X32.3INCH	162X81X82CM/63.8X31.9X32.3INCH
Gross weight	44KGS/97LBS	46KGS/101.4LBS
Net weight	35KGS/77.2LBS	38.1KGS/ 84LBS

## Matters need attention when charging

1. Before the first use of the car, make sure the battery has been charged,(4-6 hours, or the battery would be damaged permanently and cannot be repaired). When charging, first open the charging cover and then insert the plug into the charging hole, and then plug the charger into the power socket. The vehicle cannot operate during charging. (The charging process has to be operated by adults)
2. When the battery is low, please charge it in time. Normally the charging hour is 8-12 hours, but do not charge it more than 15 hours.
3. It is normal that the battery jar emits heat (below 60 centigrade), but when the temperature is too high, you should examine whether the recharging process is short-current.
4. Only chargers and battery equipped by this car can be used. Chargers and battery jars of other brand are strictly prohibited. Or the charger and battery might be damaged.
5. The car cannot be operated when charging.
6. New/old and different kinds of batteries cannot be used together.
7. Please check the circuit when the car is charging.
8. When the product is packed away or will not be used for a long time, you have to fully charge the battery and charge it once every month to guarantee the life of the battery.
9. The charger and battery is not toy. Children should not be allowed to play with them.



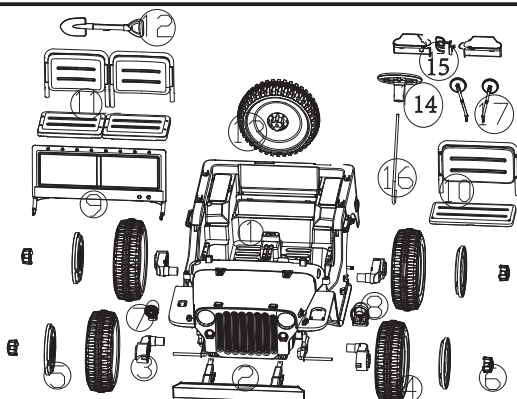

1	body	1	8	Left fancy lamp	1	15	Back bumper decoration	3
2	Front bumper	1	9	Windshield	1	16	Steering hook	1
3	Drive motor	2/4	10	Back cushion	1	17	Reflector	2
4	Wheel	4	11	Front/left/right cushion	2			
5	Wheel cover	4	12	Toy shovel	1			
6	Wheel cap	4	13	Back wheel	1			
7	Right fancy lamp	1	14	Steering wheel	1			

**Attention: Please check the vehicle accessories before assembling!**  
**Safe using matters**

- This product is not for children under 3-year old or over 8-year old.
- The assembling process could only be operated by adults.  
Pay attention to risk of sharp tips such as screw cotter pin.
- Please check whether all the part are installed well to position and connected tightly.
- This car cannot be used on dangerous places like public transport road and slopes.
- This car should only be rode under adult's supervision.
- Do not change the structure, line and additional electrical devices without permission.
- Do not switch the forward/backward frequently.
- Examine the product and charger regularly to see whether the parts are becoming old or dropped off. When damage is found, the product should be stopped using until fixed.
- Only rechargeable batteries can be used.
- Batteries can only be interposed in right poses.
- Rechargeable batteries should be taken out before used-off.
- Positive and negative poles short circuit is strictly prohibited.
- Rechargeable batteries should only be charged by adults; when playing this car, the distance between the car and an adult cannot be more than 10 meters.
- Children cannot stand in the car.
- The car is outfit with seat belt. Make sure the child has fastened it.

**Warning!**  
 When change the gear, please make sure the car is completely stopped. Or it will damage the gear case and motor.

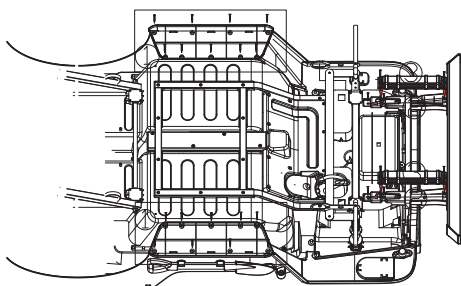

## 1. Installing front bumper and left/right support frame

- First place the left and right support frame around the body as shown in the figure, then lock and fix it with 18 M4\*12 flat head screws;
- Insert the front bumper into the body hole and then lock it with 4 M4\*12 flat head screws;
- Place the fixed beam of the front bumper as shown in the figure, and finally lock it with 4 M4\*12 flat head screws.

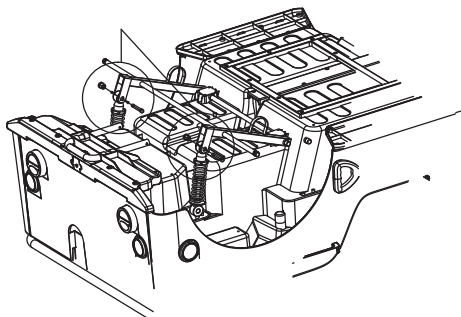

## 2. Fix the rear support frame

- As shown in the figure, after aligning the hole position of the rear axle support fixing frame and the fixed hole position of the shock absorber spring, insert an hexagon socket fixing screw and fix it with hex nut.

## 3. Installing front/rear wheel

- As shown in the figure, first load the driving motor, wheel and wheel cover into the iron shaft once; then put a gasket on each side of the nut and lock it with M10 anti-loosen nut. Finally, clamp the wheel cap on the outside of the nut.
- Then put a gasket on each side of the nut and lock it with M10 anti-loosen nut. Finally, clamp the wheel cap on the outside of the nut.

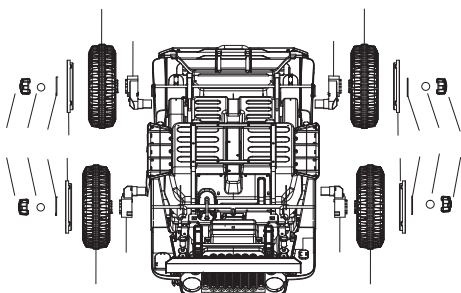

## 4. Installing steering wheel and cushion

- After inserting the steering wheel into the steering hook as shown in the figure, after aligning the steering wheel hole and the steering iron hole, insert an M5 screw and finally tighten the nut.
- As shown in the figure, place the front and rear seats on the car body, and then lock and fix them with 10 M4\*12 flat head screws.
- Insert the front and rear seat back into the body hole as shown. (note: please refer to the attached drawing for seat back removal)

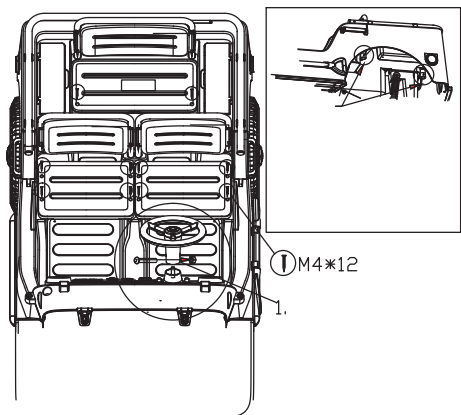

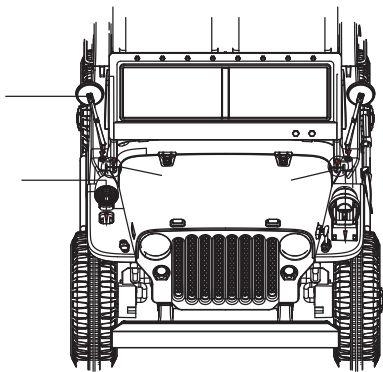

## 5. Installing windshield, left/right reflector and left/right lamp decoration

- Refer to the figure, put the L/R reflector and L/R lamp decoration into car body;
- Place the windshield as shown in the picture, then insert the wrench screw on both sides of the iron piece and lock it with the embedded nut.

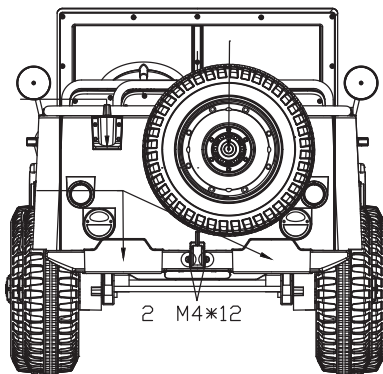

## 6. Installing the rear spare tire, the flagpole base and the rear bumper decoration

- As shown in the figure, assemble the rear spare tire, the flagpole base and rear bumper decoration on the back of the car body.

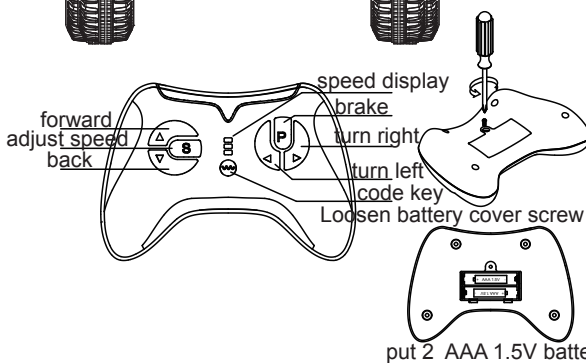

## 7. 2.4G remote control instruction

For the first time, it needs to check the code, this product has built-in memory, and there is no need to check the code for battery replacement later.

- Turn off the power and hold down the "M" button of the remote control. After 3 seconds, the first indicator light will flash, and then release the button.

2. At this point, turn on the power switch, the first indicator light of the remote control changes into the state of constant light, the code successfully.

3. When the remote control is not in use, it will enter the sleep state after 10 seconds and press any key to wake up.

4. Key function description: "▲" forward, "▼" back, "◀" turn left, "▶" turn right, "S" adjust speed, "P" brake. Press "S" key to adjust the speed, one light for low speed, two lights for medium speed, and three lights for high speed, astern only at medium speed. Press P to enter the brake state, all the indicators flash, press P again to exit the brake state.

Warning! This product is not for kids under 3-year-old,  
keep small components away from children. Danger for asphyxia.

- Refer to the figure, put 2 AAA (1.5V) dry batteries.
- Use non-rechargeable batteries and these batteries cannot be recharged.
- New/old and different kinds of batteries cannot be used together.
- Positive and negative poles short circuit is strictly prohibited.
- Used-off batteries should be taken out of the toy and dealt properly to prevent kid's playing.
- The positive and negative extremes of the power supply must not be short-circuited.
- Keep the instruction for further reference.

## 8. Charging instruction

- When the battery voltage displayed on the right side of the instrument panel is less than 20V, the battery is insufficient. Please timely charge the battery. The charging box is shown in the hood.
- During charging, the vehicle is in charge protection state and the power supply of the vehicle cannot start. After the charging hole is pulled out from the charging seat, the whole car is adjusted to the normal mode.

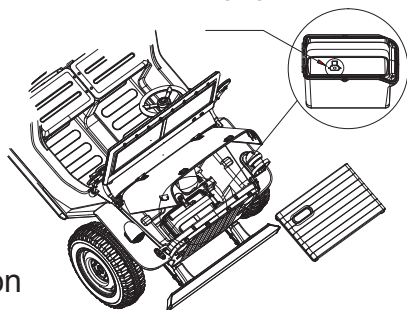

## 9. Indicator diagram of platform function

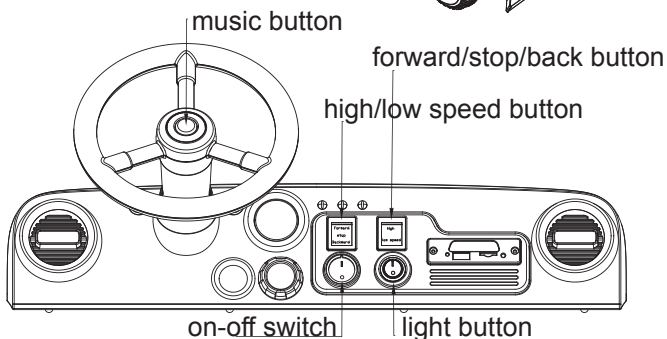

- On-off switch—(1) The platform is energized, the lighting system lights up with the engine sounds; (2) The dashboard is equipped with a music function operator, which can be connected to the mobile phone B))) device, volume adjustment, power display and other functions.
- Steering wheel—(1) the steering wheel is equipped with music buttons.
- The lighting system switches with one button—(1) Light can be turned on and off.
- High low speed switch—(1) This car can switch between high speed and low speed freely, having different driving pleasure.

## Simple maintenance

Fault type	Reason analysis	Exclusion methods
Car's not moving	Battery has low voltage	Recharging the battery
	Battery is broken	Replace new battery
	The nut of the wheel is dropped off	Screw the nut on
	Motor is broken	Go to the maintenance area
	Socket connector of the battery has been missing	Replace new socket connector
	Fuse wire is broken	Change a new fuse
	Power is turned off	Turn on the power
Low speed	Battery is without power	Recharge the battery
	Dead battery	Change motor
	Pavement irregularity	Ride on smooth-riding surface
	Overload	Reduce weight
	Battery is old	Change new battery
Battery cannot be recharged	Charger or motor is broken	Change new charger or motor
	Socket connector of battery is broken	Change new socket
	There is no power	Plug it in
Short flight mileage	Battery off	Recharging the battery
	Battery is old	Change a new battery
Car is shaking when progressing	Connector cable for lens motor contact poorly	Reconnect it
	There's dead spot on the motor	Repair it in maintenance point
Car has noise when progressing	Gear case is broken or run out of gas	Replace gear case or supply gas
	Gear is broken	Change a new gear

## Matters needing attention

- The product should be assembled correctly by adults before usage.
- Keep away from children under 3 or over 8.
- Battery charging process should be performed by adults.
- Ensure a 10-hour-long battery charging process before the first use; otherwise the battery will suffer permanent damage.
- Keep away from dangerous areas like street/road/slippery areas etc.
- For three people weighting less than 60KG/ 132.3LBS only.
- Make sure the safety belt fastened and the child seated.  
Dangerous actions as well as standing up are forbidden.
- Do not press the forward/back button abruptly while driving.
- Do not drive in narrow space, in order to avoid damage to the product.
- Go on periodic check.  
Pay close attention to the security situation of the product and its peripheral equipment.
- Pull out the battery during the long period without use.
- The product should be used with adult guardianship.