

Description

Name	DK-CA001
Battery	12V10AH / 12V14AH / 12V10AH*2 / 12V14AH*2 / 24V7AH / 24V7AH*2
Motor	12V12000 RPM of driving motor 12V3000 RPM of steering motor 24V22000 RPM of driving motor (2 Motors) 24V12000 RPM of driving motor (4 Motors) 24V3000 RPM of steering motor
Maximum weight	50KGS/110LBS
Dimension	1450*845*795 mm / 57.1*33.3*31.3 INCH
Speed	3-8 KM/H / 1.86-4.96 MPH
Charging time	8-12 hours
Remote control battery	AAA battery 1.5V*2 (not including)
Applicable age	37-95 months
Charger specification	Input: 220V / 110V Output: DC12V1000mA / 28.8V800mA

Charging the Drive Battery:



IMPORTANT! Before using the unit for the first time the battery needs to be charged for at least **8 to 12** hours - no more than **20** hours. Once battery is depleted, recharge for **8 to 12** hours - no more than **20** hours.

IMPORTANT!

Check the drive battery and charger (supply cord, connector) for wear and damage before charging. Do not charge the battery if damage has occurred. Only replace with the same type and voltage rechargeable battery and charger supplied by the manufacturer.

- Only use the rechargeable battery (or equivalent replacement) and charger supplied with your vehicle.
- Always turn power off and charge battery after riding.
- The drive battery should be charged when depleted, or if not used regularly, once a month. Failure to charge the battery as directed will cause permanent damage to the battery and will void the warranty.

STEPS:

1. Locate Charging Port.
2. Plug Charger plug into unit Charging Port.
3. Plug Charger into Wall outlet.
4. When battery is fully charged, unplug charger from the wall outlet and disconnect from charger port.

NOTE: The charger may feel warm during the charging. If excessively hot, unplug and replace.

NOTE: This product has charging protection: When charging, all functions are turned OFF.

CAN AM MAVERICK UTV



Model: DK-CA001

Applicable age: 37-95 months

Maximum weight: 50KGS/110LBS

Execution Standard:

GB6675&GB19865 EN71&EN62115 ASTM-F963



The BRP, Can-Am, Rotax, and Maverick trademarks, logos and designs are the intellectual property of Bombardier Recreational Products Inc. and are used under license by Pinghu Dale Baby Carrier Co., Ltd.

Installation steps

1.Spare parts list

Car body 1 PC	Front guard bar 1 PC	Left guard bar 1 PC
Right guard bar 1 PC	Rear guard bar 1 PC	Steering wheel 1PC
Seat 2 PCS	Driving motors 2 or 4 PCS	Front wheels 2 PCS
Rear wheels 2 PCS	Wheel covers 4 PCS	Rear axle 1 PC
Charge 1 PC	Remote control 1 PC	Manual 1 PC
Socket wrenches 2 PCS	M12 Gaskets 6 PCS	M4*10mm Screws 24 PCS
M10 Nut 1 PC	Bolt 1 PC	
MP3 line 1 PC(not including under the MP4 version)		
M16 Gaskets 2 PCS (only including under the 2 motors version)		

2.Part name

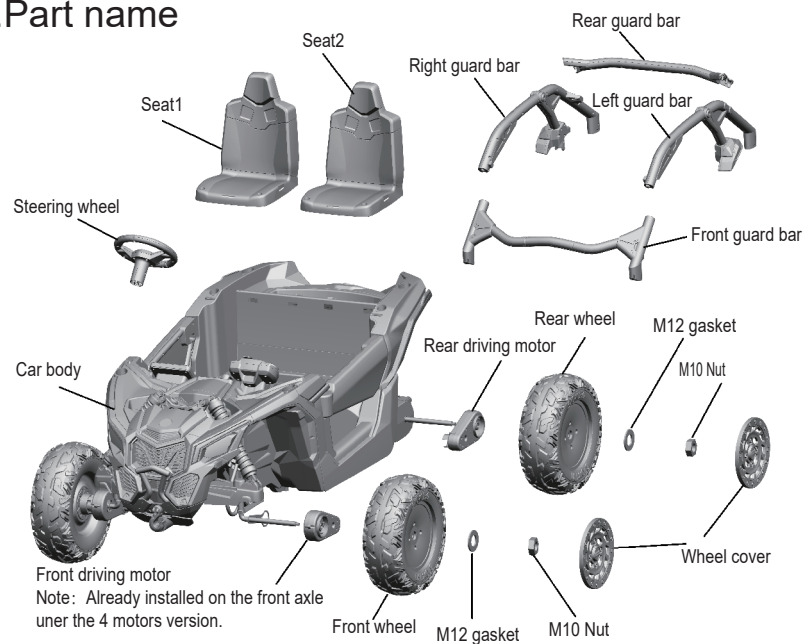

Instructions

- While driving , adult supervision is required all the time
- Always wear a helmet when driving
- Please don't drive near road or on the footpath.
- It is not recommended to drive the vehicle on wet surface or on slope greater than 15-degree.
- It is recommended to drive this vehicle on smooth surface only.
- Please don't drive this vehicle outdoors when it is raining.
- Make sure that the vehicle stop completely before changing direction from forward to reverse
- Please don't allow children to operate the charger or play with the battery
- Clean the vehicle with a dry cloth only.
- Please follow the correct weight and age limits allowed to drive this vehicle.
- It is prohibited to change the circuit or add other electric parts.
- Adults must teach their children about safe driving procedures.
- Please turn the power off when not in use.
- Check the seat to ensure it has been fitted and secured with a bolt before driving.
- Inspect all wires and connection of the vehicle periodically.
- Charging the battery should only be done by adults.
- Charging plug is located underneath the seat.
- In order to avoid accidents, please ensure the vehicle is safe before driving.
- Please don't let children touch the wheels or be near them when the car is moving.
- Please mind fingers when opening and closing doors.

WARNING:
To reduce the risk of injury, adult supervision is required. Never use in roadways, near motor vehicles, on or near steep inclines or steps, swimming pools or other bodies of water; always wear shoes, and never allow more than 2 riders.

Warning: This toy has no brake.

WARNING!

For safety reasons,
 *please use this vehicle under adult guidance and supervision.
 *do not use this product on main roads, slopes, highways or other dangerous places.
 *children must wear shoes and protective gears when operating the vehicle.
 *children should be seated with the seat belt fasten when driving.
 *only load a maximum of 50Kg on the vehicle.
 *only children aged 37 - 95 months should be allowed on this vehicle.
 *use this toy strictly according to safety manual.
 *please check the tires, breaks, steering wheels, seats and seat belts before operating vehicle.
 *this toy vehicle should be used with caution and requires skill to avoid fall or collision with third parties.
 *Non-rechargeable batteries are no to be recharged;
 *The supply terminals are not to be short-circuited.
 *Rechargeable batteries are to be removed from the toy before being charged;
 *The toy should be regularly examined for damage to the cord, plug, enclosure and other parts, and in the event of such damage, they must not be used until the damage has been repaired.
 -Only use the battery specified by the manufacturer.
 -Only use the charger specified by the manufacturer.
 Pictures are for reference only, please adhere to the original Products as standard

The product must be assembled by Adults.

Warning! Not suitable for children under 36 months.

Long cord. Strangulation hazard.
 Pictures are for reference only, please adhere to the original products as standard

WARNING:
The car contains battery that are non-replaceable.

The instruction manual must be retained since it contains important information.

WARNING:
For the purposes of recharging the battery, only use the detachable supply unit provided with this toy.DC adaptor.

WARNING:
The remote control is not a toy. It is for adult use only, and should not be used by a child. A close adult supervision is always required. Reception range may change significantly with weather, battery, and other environmental conditions.

WARNING:
RISK OF FIRE.DO not bypass.Replace only with JR1922RXS DO 12V Max35.

Troubleshooting

Problem: The vehicle cannot be driven.

Cause of the problem: the battery is insufficient

Please charge in time after each use, and charge at least once a month.

It is recommended to charge for 8-12 hours, not more than 20 hours.

Problem:The car does not move.

Answer : The battery is low, please charge for 8-12hours

but not exceeding 20 hours.

Charge at least once a month to keep the battery cells active.

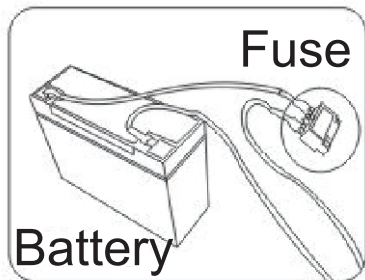

To avoid short fuse or power cut off:

1. Do not overload the product. Max load is 50 Kg.
2. Do not drag any item behind this product.
3. Do not allow water or any liquid into electric parts.
4. Do not change wire system without a professional.

TROUBLESHOOTING

Problem:The car only runs for a short time.

Answer 1: The battery is low, please charge for 8-12hours

but not exceeding 20 hours.

Charge at least once a month to keep the battery cells active.

Answer 2: The battery may need to be replaced depending on its charging history and age.

Problem:The sound does not work.

Please ensure the volume is turned up and the MP3 line is not connected. Sounds from steering wheel will not work when MP3 is plugged in.

Problem:Charger overheating.

It is normal for battery and charger to be slightly warm during charging. If the charger feel excessively hot, please check for a current overload or battery short circuit.

Installation steps

Step 1: Adjust front axle

- A. Take off the M6*13mm screw and nut, and then adjust the front axle (steering link) referring to the figure 3-1.
- B. Insert the steering axle into the hole of front axle(steering link), and fix it by using 1 pc of M12 gasket and cotter pin referring to figure 3-2;
- C.Insert M6*13mm screw again to the hole and screw on the M6*13mm nut.

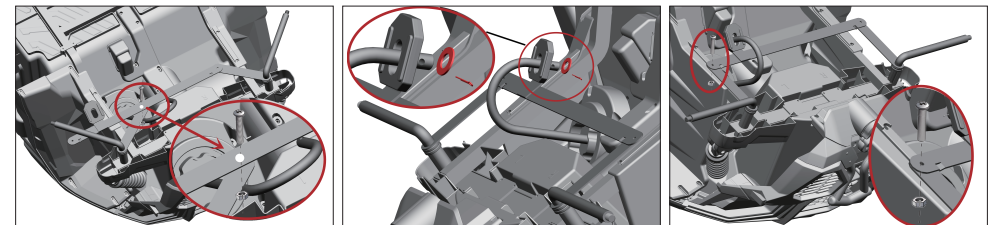

Step 2: Install front wheel

- A. Under the 4 motors version:

Install the spare parts onto the front axle according to the sequence as below :

Front wheel - M12 gasket - M10 nut - Wheel cover - M4*10mm screws 4 PCS

- B.Under the 2 motors version:

Install the spare parts onto the front axle according to the sequence as below :

M16 gasket - Front wheel - M12 gasket - M10 nut - Wheel cover

- M4*10mm screws 4 PCS

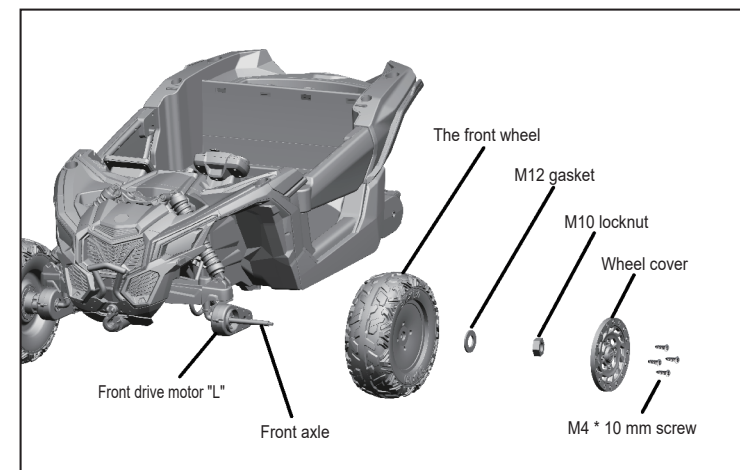

Installation steps

Step 3: Install rear wheel

- Insert rear axle into the car body, and install "L" "R" driving motors onto the rear axle, and then connect the cables.
- Install the spare parts on the rear axle according to the sequences as below:
Rear wheel - M12 gasket - M10 nut - Wheel cover - M4*10mm screw 4 PCS

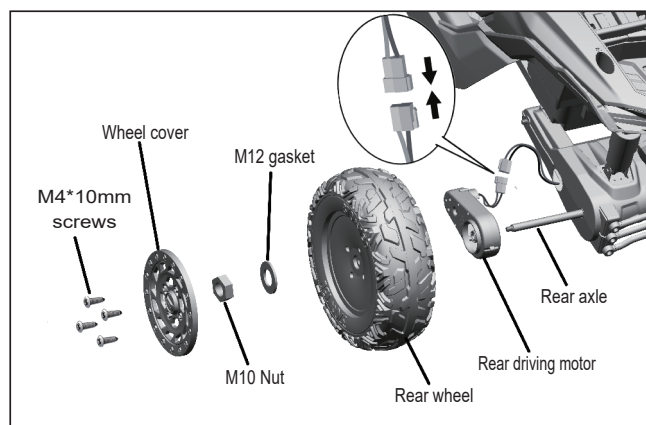

Step 4: Connect the power

Connect the power cable according to the figure below.

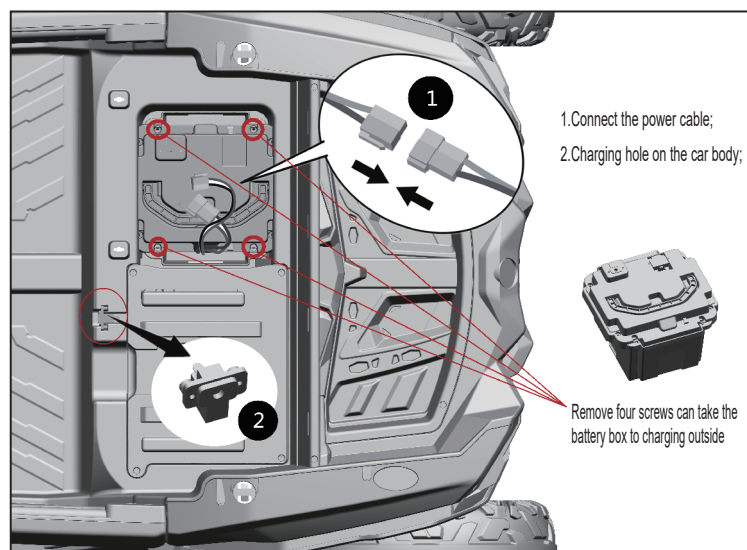

Instructions

6. Remote control frequency matching

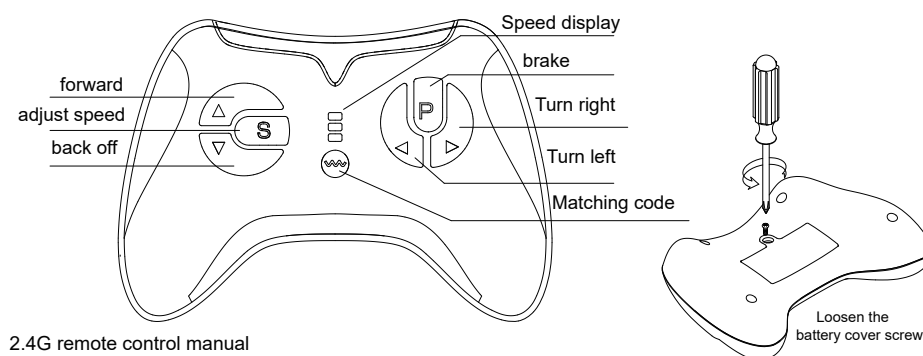

2.4G remote control manual

he first use requires code matching. This product has built-in memory, and it is unnecessary to code after replacing the battery.

- Turn off the power of the car body, press and hold the "m" key of the remote control, the first indicator light starts to flash after 3 seconds, and then release the key
- At this time, turn on the power switch of the car body, the first indicator light of the remote control will become normally on, and the code matching is successful
- When the remote control is not in use, it will enter the sleep state after 10 seconds. Press any key to wake up.
- Key function description: "forward", "backward", "left", "right", "s" speed regulation, "P" brake.

Press the "s" key to set the speed, one light is low speed, two lights are medium speed, three lights are high speed, only medium speed when reversing

Press the "P" key to enter the braking state, the indicator lights all flash, and press the "P" key again to exit the braking state

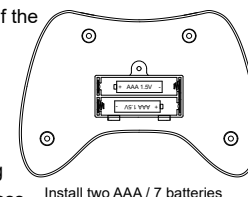

7. Remote control instructions

Warning! It is not suitable for children under 3 years old.

There are small parts inside and there is a risk of suffocation

- Install two AAA / 7 (1.5V) dry batteries as shown in the figure
- Use a non rechargeable battery, do not charge the battery
- Different types of batteries or old and new batteries cannot be mixed
- Take out the battery from the product in time when the battery runs out
- The positive and negative terminals of the power supply shall not be short circuited
- The package of this product contains important information, please keep it

Warning! The remote control should be used by a guardian.
There are small parts inside and there is a risk of suffocation.
Please keep away from children.

Directions for use

4: Introduction for Dashboard

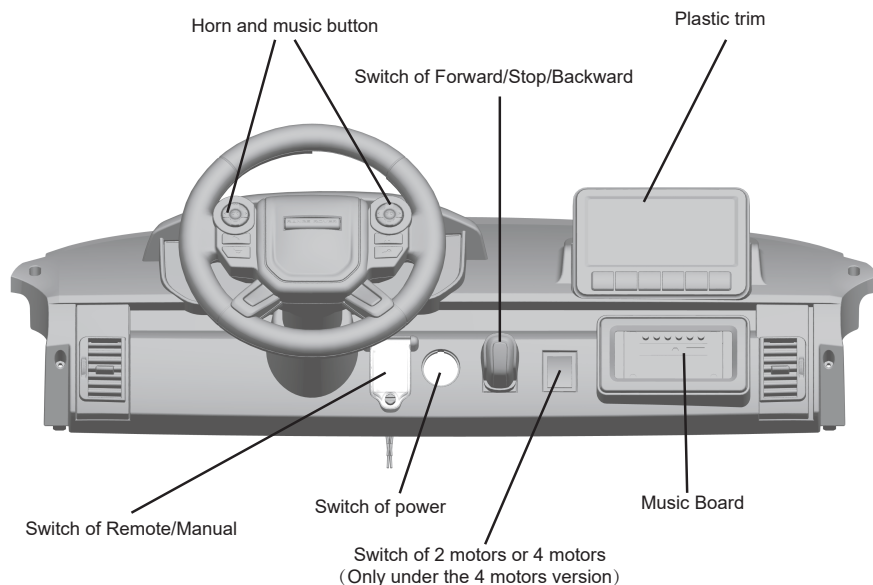

Description for the switch of Manual / Remote:

Under the Manual: the car only can drive by the child;

Under the Remote: the car only can drive by the remote control;

5: Introduction for music board

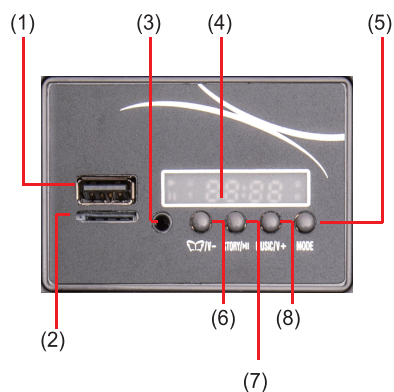

1. socket
2. Storage card socket
3. Audio input
4. Display
5. MODE choose(Radio/wireless connection/Storage card connection)
6. Education(Pressing for a longer time and it will lower the volume)
7. Story(Play/ Pause under the wireless connection/Storage card functions)
8. Music(Pressing for a longer time and it will higher the volume)

Installation steps

Step 5: Install the seat 1

- Put the seat into the seat space.
- Lock the screws.

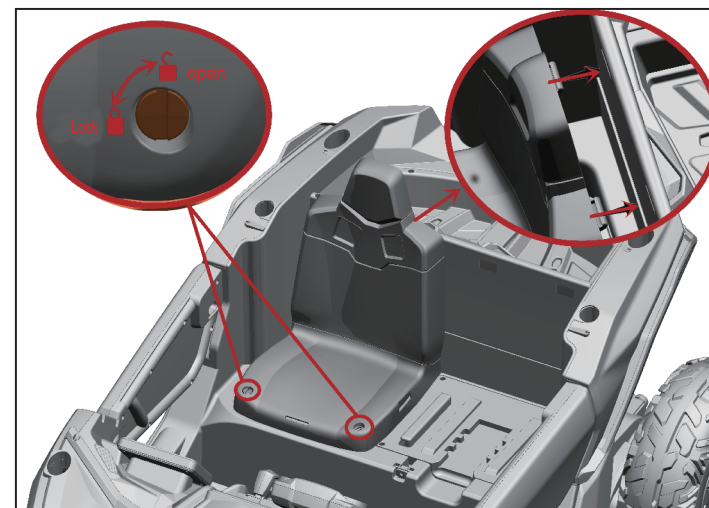

Step 6: Install the seat 2

- Pull the seat 2 with the sliding handle on the seat 2 as shown in the figure;
- Pull the seat 2 to the end to place it in the car body slot.

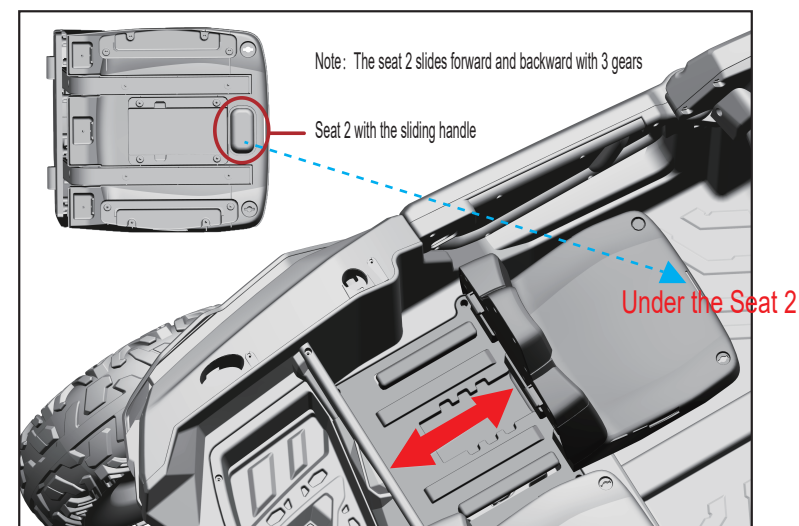

Installation steps

Step 7: Install the steering wheel

- Connect the cables of steering wheel with connectors of dashboard.
- Put the steering wheel into the space of dashboard, fix it by using M5*35mm screw and M5 nut.

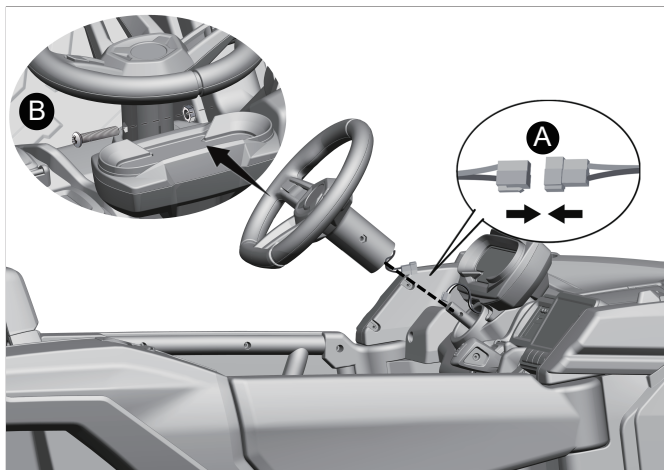

Step 8: Install the front safety guards

- Install the front safety guards into the car according to the figure below.
- Fix it by using M4*10mm screws 2 PCS.

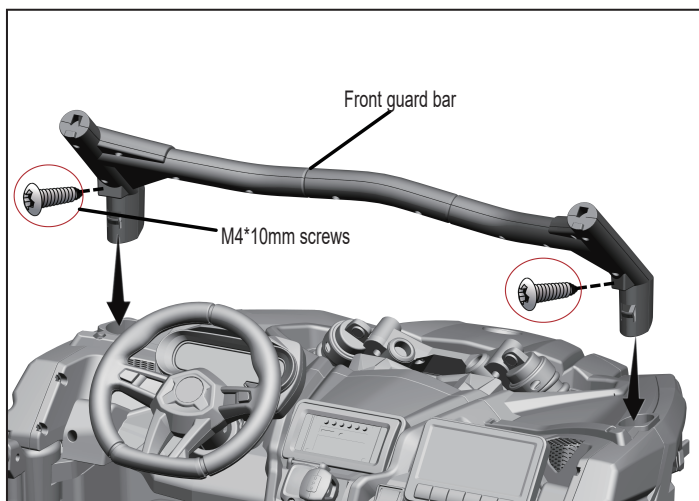

Step by step

Step 9: Assemble the left, right and rear guard bars

- Connect left, right and rear safety guards according to the figure below, and fix them by using M4*10mm screws 4 PCS.

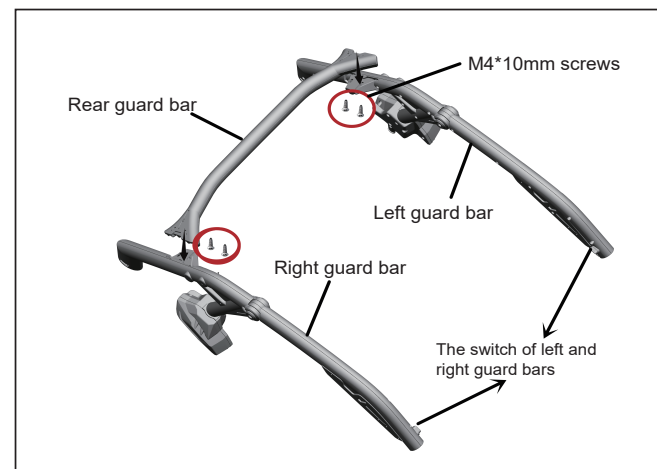

Step 10: Install the left, right and rear guard bar

- Place the left, right and rear guard bars in the car body slot.

