

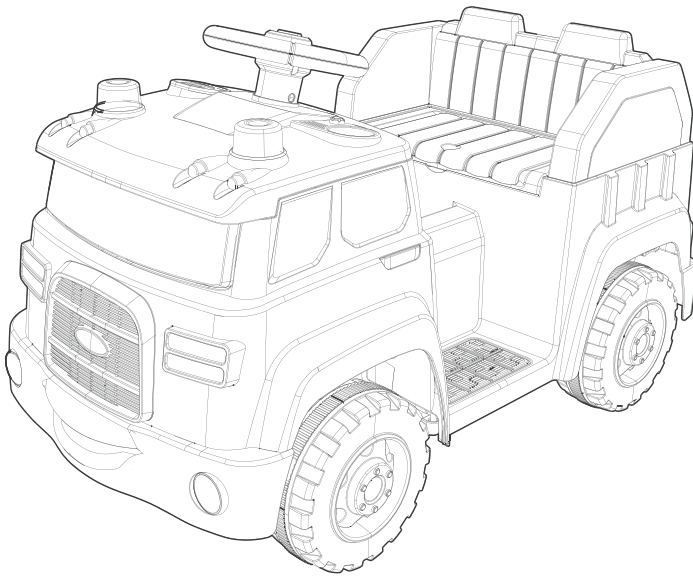

DUMP TRUCK



OWNER'S MANUAL

Read and understand this entire manual before using:

**Please keep this manual for future reference as it contains important information.
Before first time use, charge the battery for at least 8-12 hours, no more than 20 hours.**

Table of Contents

Would you please to read this specification carefully before installation in order to avoid operating errors or damages. Make sure that the baby will be safe . The user should safe keeping the specification.

Specification

Storage battery	12V4.5AH*1
Electric motor	12V380*2(drive)12V380*1(turn)
Suit age	3+years
Load capacity	under 55lb(25KGS)
Size	35.83*19.69*21.26in (91x50x54cm)
Speed	1.9mph-3.1mph(3.0-5.0 km/h)
Utility	8-12hours(charge),60-80minutes(Use)
Charger	AC 110-240V ,50-60Hz(input),DC12V(output)
Battery of remote control	Two pieces of AAA 1.5V













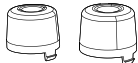

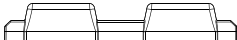
WARNING!

FOR THE SAFETY OF YOUR CHILD, PLEASE READ ALL WARNINGS AND ASSEMBLY/USE INSTRUCTIONS. KEEP THIS GUIDE FOR FUTURE REFERENCE.

- **ADULT ASSEMBLY REQUIRED.** The product contains small parts, which are for adult assembly only. Keep small children away when assembling.
- Always remove protective material and poly bags and dispose before assembly.

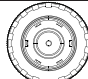
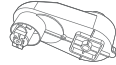
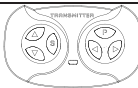
Parts list

PART NO	PART NAME	PICTURE	Qty
1	Steering wheel		1
2	Battery charger		1
3	Alarm lamp		2
4	Seat		1
5	Seat backrest		1
6	Card		9
7	Recycling truck body		1
8	Instruction Manual		1
9	Wheel cover		4
10	Cotter pin		4
11	Washer		6
12	Wheel		4
13	Gear box		2
14	Remote control		1
15	MP3 Line		1

Parts

Before you begin assembling, check that all parts listed are present.

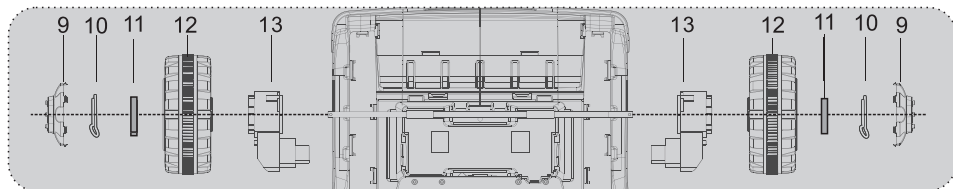
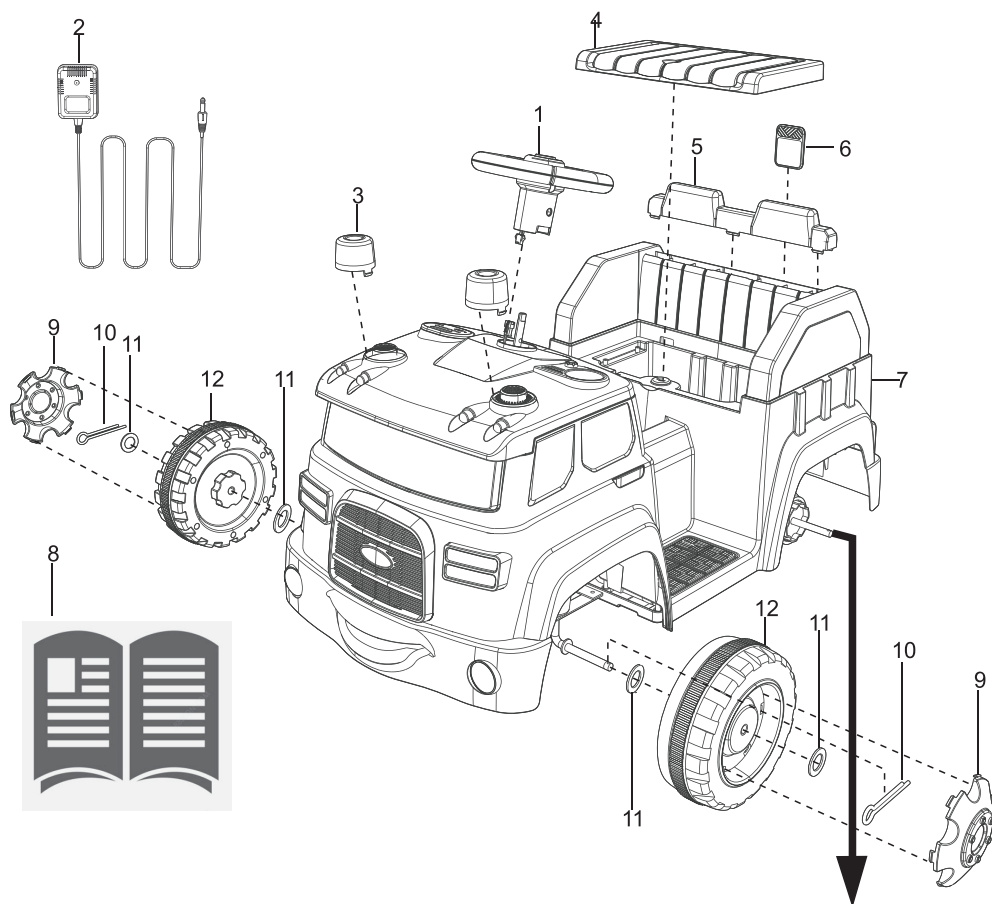

Assembly: Install the drive motor

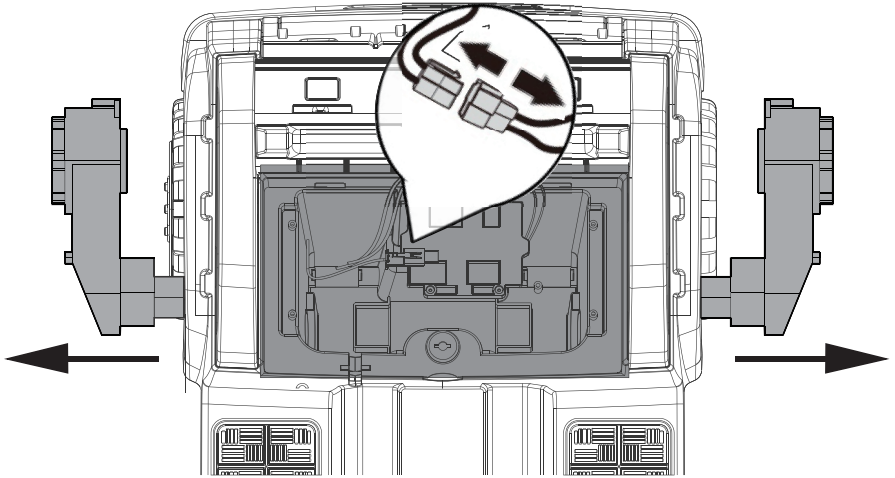

- Disconnect the power cord and remove the motor from the battery compartment.
- Install the drive motor into the rear axle and connect the power cord.

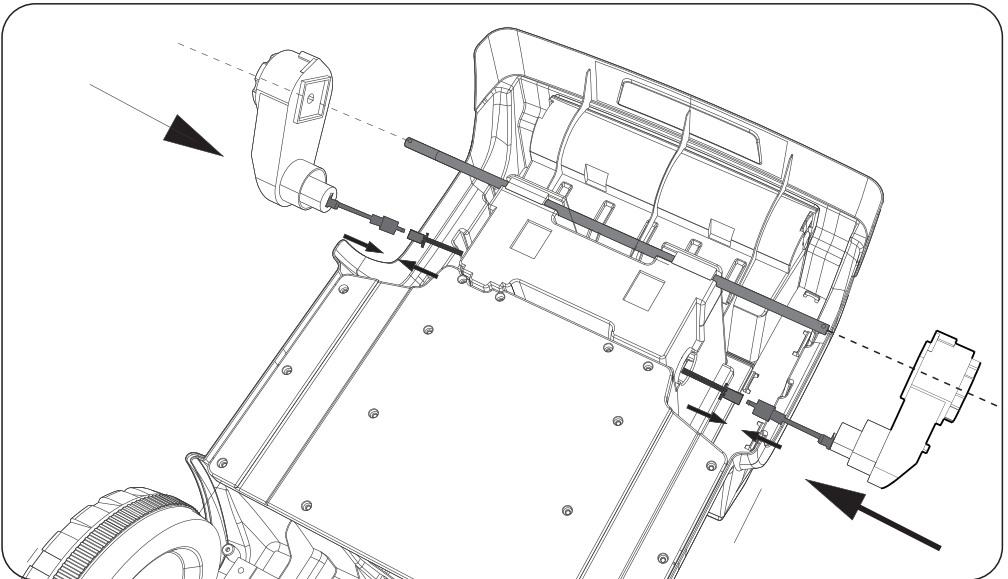

Assembly: Install the rear wheels

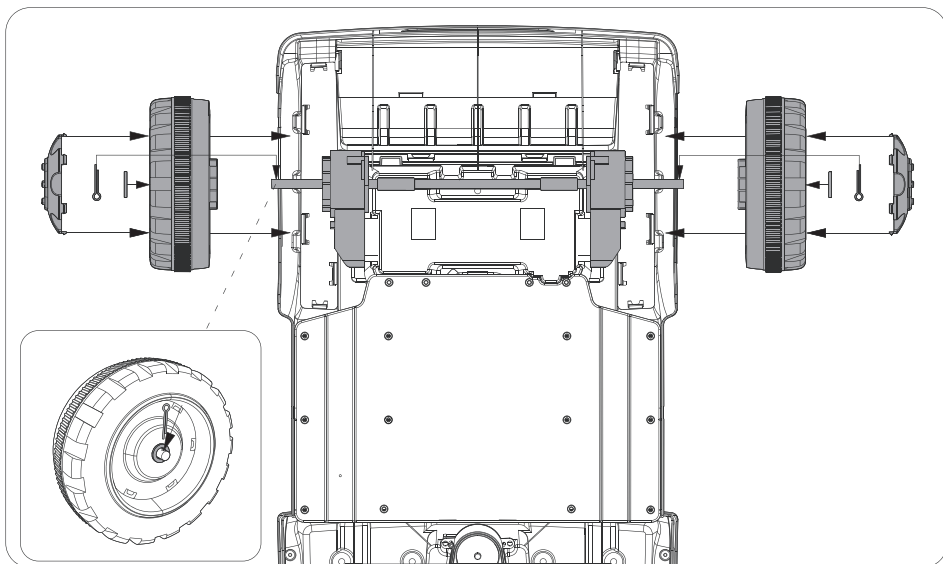

- Insert a rear wheel on the each side of the rear axle.
- Insert a washer on each side of the rear axle.
- Insert the end of the cotter pin through the hole at the end of axle until they snap into place.
- Press the wheel cover into the slots of the wheel until they snap into place.

Assembly: Install the front wheels

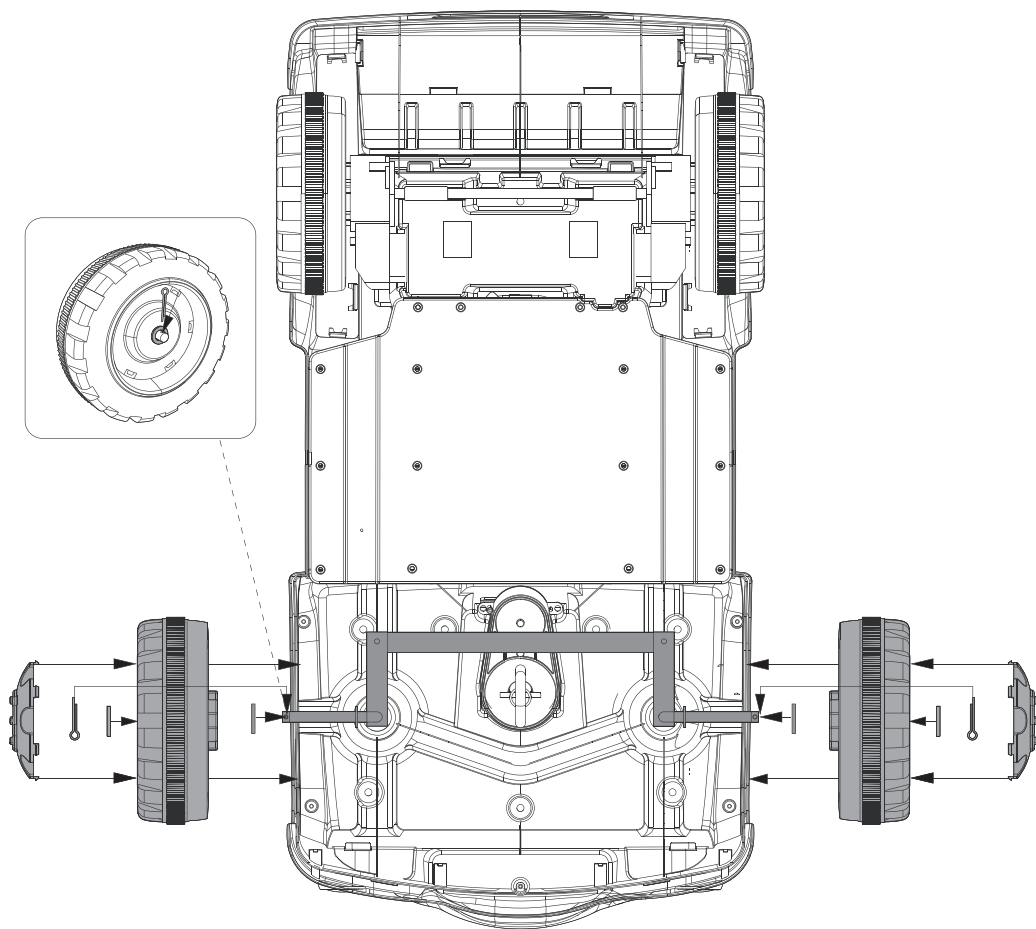

- Insert a washer and front wheel on the each side of the front axle.
- Insert a washer on each side of the rear axle.
- Insert the end of the cotter pin through the hole at the end of axle until they snap into place.
- Press the wheel cover into the slots of the wheel until they snap into place.

Assembly: Install the seat backrest and the steering wheel

- Insert the seat backrest into the body.

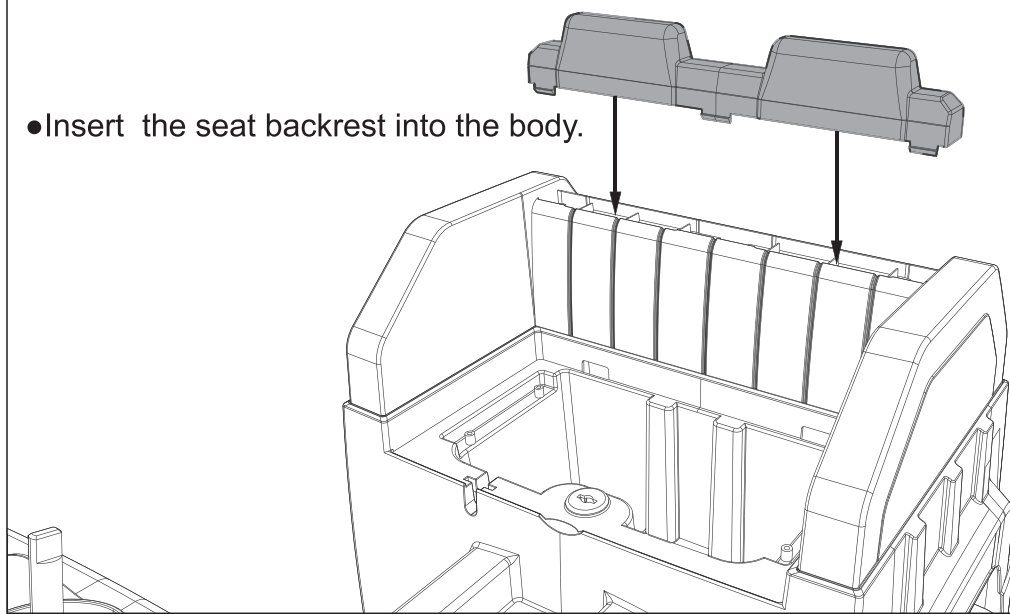

Note: Remove the nut and bolt before installing the steering wheel.

- Attach the wires coming from the steering wheel to the wires coming from the steering column
- Completely align the holes in the steering wheel with the holes in the steering column
- Insert the bolt through the steering wheel and fasten with the nut

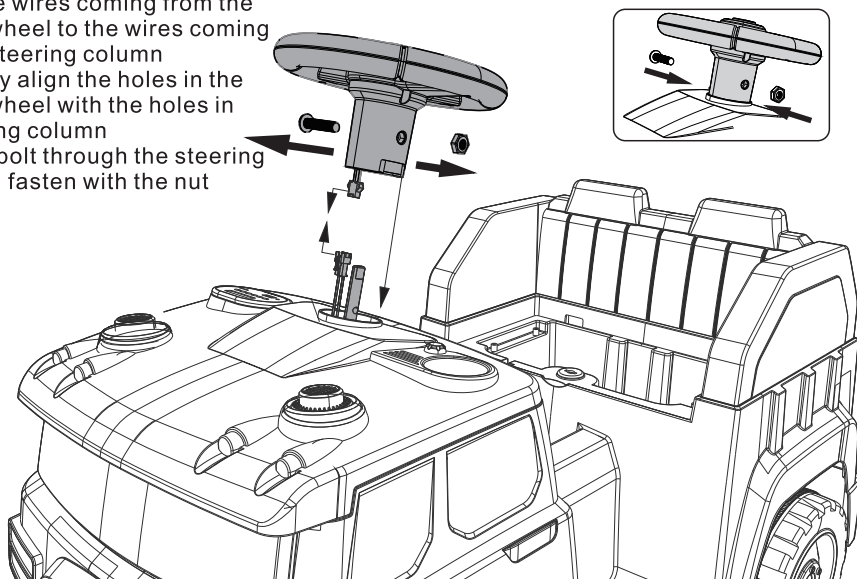

Assembly: Install the alarm lamp

Install the alarm lamp in the card slot in the front of the truck.

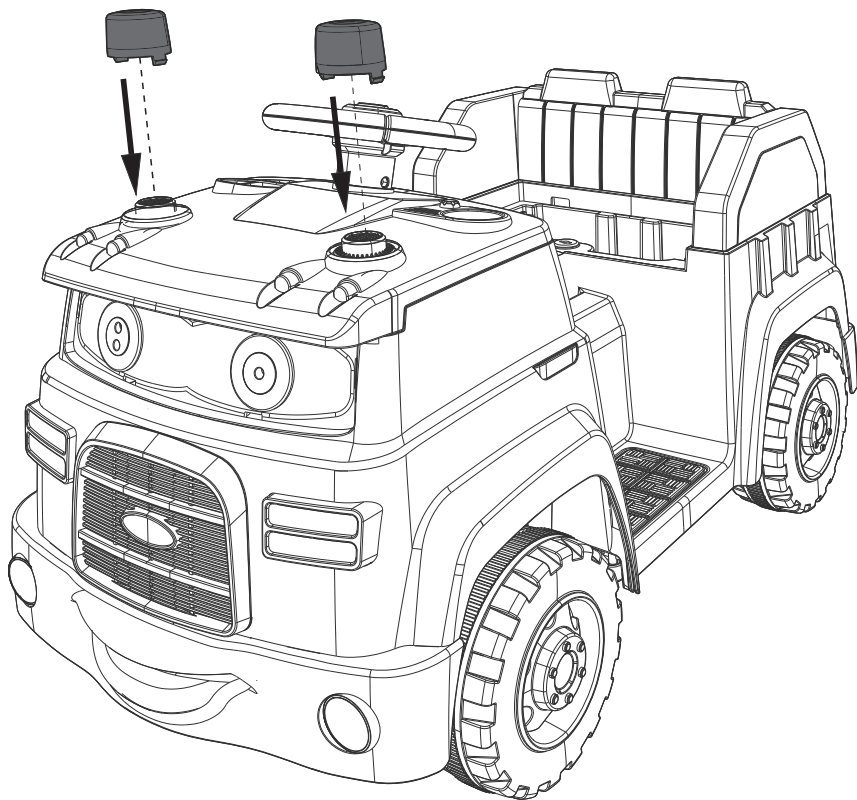

Assembly: Install the seat

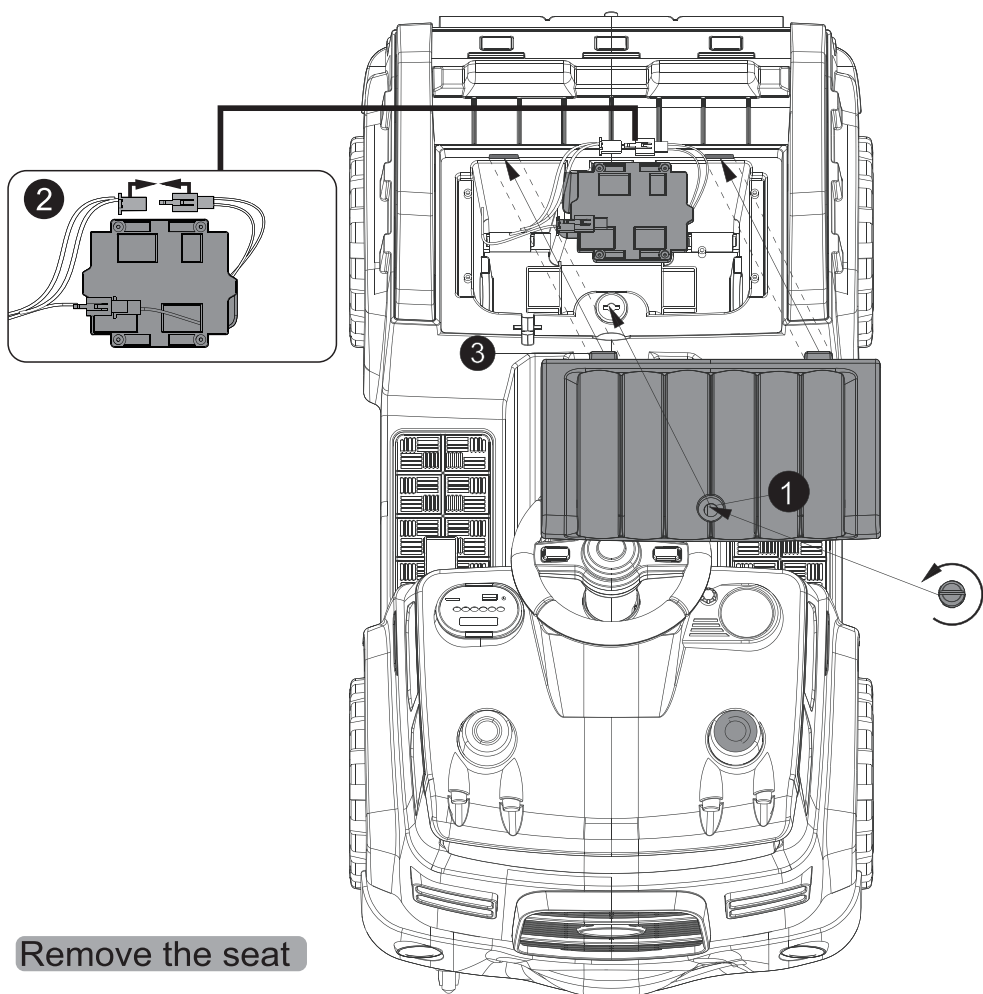

Remove the seat

- Loosen the Seat latch on the seat and lift off to expose the battery compartment

Make the one-time battery wire connection

- Attach the red wire connectors

Re-attach the seat

- Insert the tabs of the seat into the seat slots and tighten the Seat latch

Controls and Functions

- Put the cards in the corresponding hole.

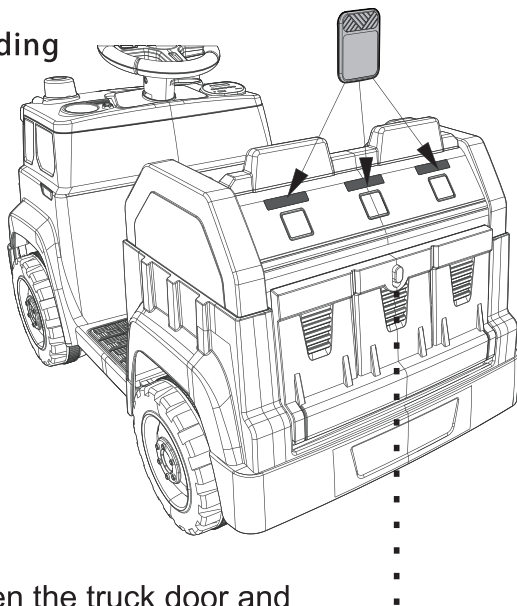

Open the trunk door

- Press this button, you can open the truck door and take out the cards.

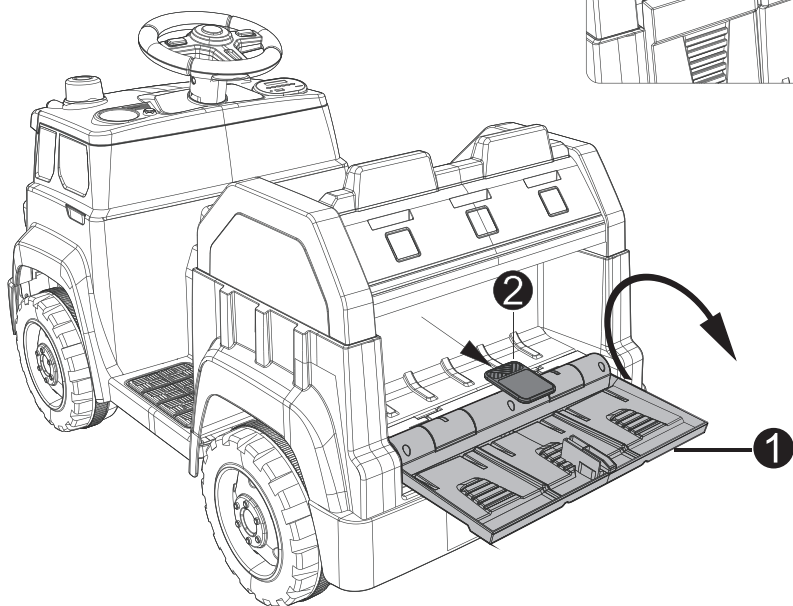

USE

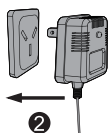

⚠ WARNING!

The product with Charging Protection :
when charging ,all functions will be cut off!
Only an adult can charge and recharge
the battery !

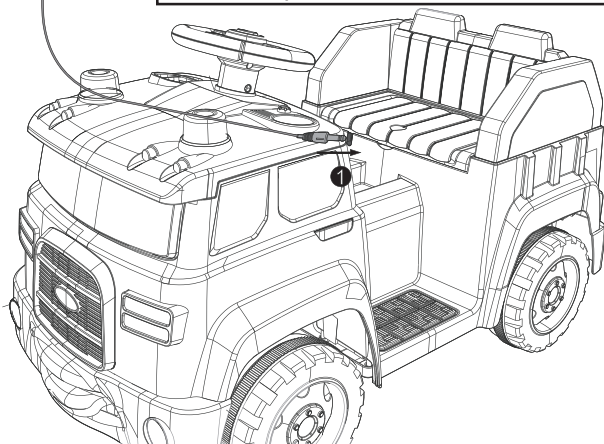

Controls and Functions

1.Horn/Music Button

2.MP3 player

3.On/Off Switch

4.Foot Pedal

5.Forward/Backward Switch

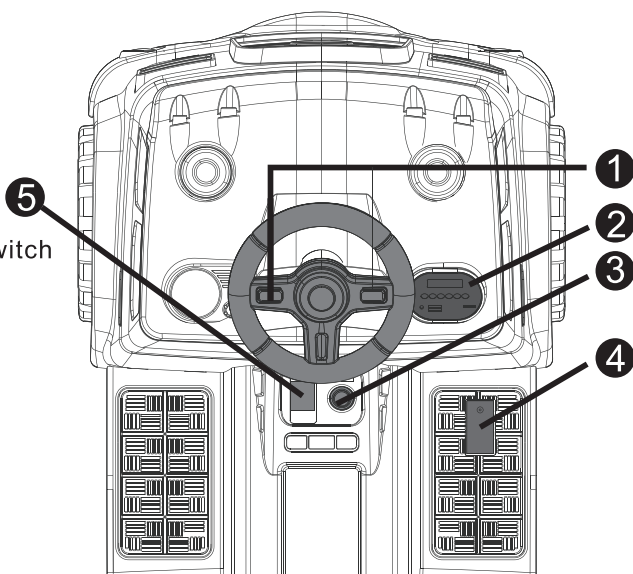

How To Operate Your Vehicle

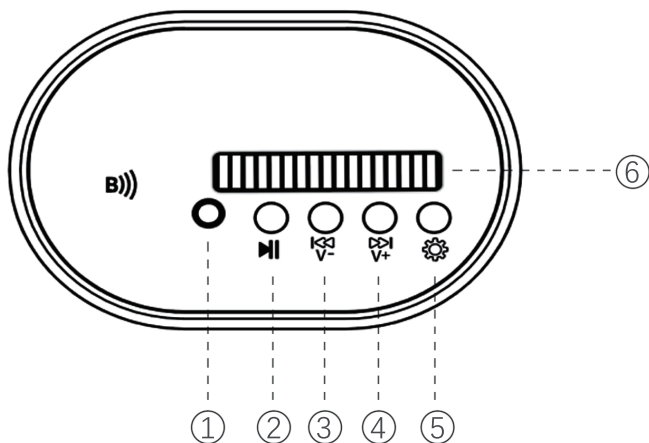

- 1.MP3 Slot:**Through the data line can be connected to other devices and play audio.
- 2.Play/Pause:**Press the button it can play and pause.
- 3.Previous/decrease volume:**Press the button short time,play previous song;Press the button long time ,the volume will decrease.
- 4.Next/increase volume:**Press the button short time,play next song; Press the button long time,the volume will increase.
- 5.Mode Button:**Press the button to change the audio input.
- 6.Power display:**Clearly see the battery power,in order to charge in time.

(6)How To use the steering wheel button

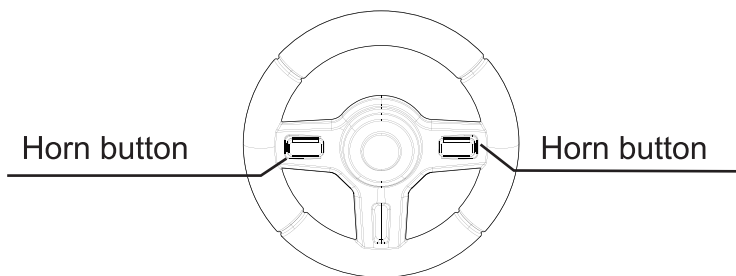

How To Operate Your Vehicle



PREVENT INJURIES AND DEATHS:

- **NEVER LEAVE CHILD UNATTENDED. DIRECT ADULT SUPERVISION IS REQUIRED.** Always keep child in view when child is in vehicle.
- Never use in roadways, near cars, on or near steep inclines or steps, swimming pools or other bodies of water.
- Always wear shoes.
- Always sit on the seat.
- Suitable for age 3+ years, Maximum user weight is 55lb(25KGS)
- Not to be used in traffic .

Must confirm before using that following work which is already finished:

- **Important!** Before using the vehicle for first time, the battery needs to be charged for 8 to 12 hours, no more than 20 hours. Only an adult can charge or recharge the battery.
- Finishing the complete car to assemble according to the steps that the manual described. The plug-in package of storage battery has already been inserted well, the power has already been put through.
- All places to need the screw guarantee the screw has already been locked.

Rules for Safe Riding

READ THESE RULES ALOUD TO YOUR CHILD AND THEIR PLAYMATES AND MAKE SURE THEY UNDERSTAND THEM!

- This toy is no break. Always wear a helmet and protective clothing when riding.
- Direct Adult Supervision Required.
- Keep Children within Safe Riding Areas.
- Never driving in roadway, near motor vehicles, on lawn space, on near steep inclines or steps, swimming pools or other bodies of water.
- Use the toy only on flat surfaces. such as inside your house, garden or playground.
- Never use in the dark. A child could encounter unexpected obstacles and have an accident. Operate the vehicle only in the daytime or a well-lit area.
- It is not recommended to drive the vehicle on wet surfaces or on lopes of greater than 15 degrees.
- Do not use this vehicle outdoors when it is raining or snowing.
- Make sure you come to a complete stop before changing directions from forward to back.
- Please follow the correct weight and age limits allowed to drive this vehicle.
- It is prohibited to change the circuit or add other electric parts
- Inspect wires and connections of the vehicle periodically.
- In order to avoid accidents, please ensure the vehicle is safe before riding.
- Do not let any child touch the wheels or be near them when the car is moving .
- This vehicle has adjustable play seat belts. please instruct children how to tie the safety belt before using, guarantee the security.

How To Operate Your Vehicle

Remote Control Instructions

(1). Open the battery cover of remote control and load into 2 pcs AAA(1.5V)batteries.(Not included)

(2). Instructions

a. First time use need to match code, this product has memory function

Replace battery is unnecessary match code

b. Hold down “▲” & “▼” keys for 3 seconds start match code, The first LED flicker

c. Turn on the car body power now, Wait for a moment, the Speed display red light stop flashing, code success.

d. Remoter 10 seconds not run will be standby ,Press any key wake up

e. Keys caption : “▲” Forward, “▼” Back, “◁” Left, “▷” Right, “S” Speed, “P” Brake.

Press “S” key set up speed , 1 led lit up is low speed , 2 leds lit up is medium speed , 3 leds lit up is high speed , Back a car is only low speed

Press “P” key hold the brake, All LED flicker

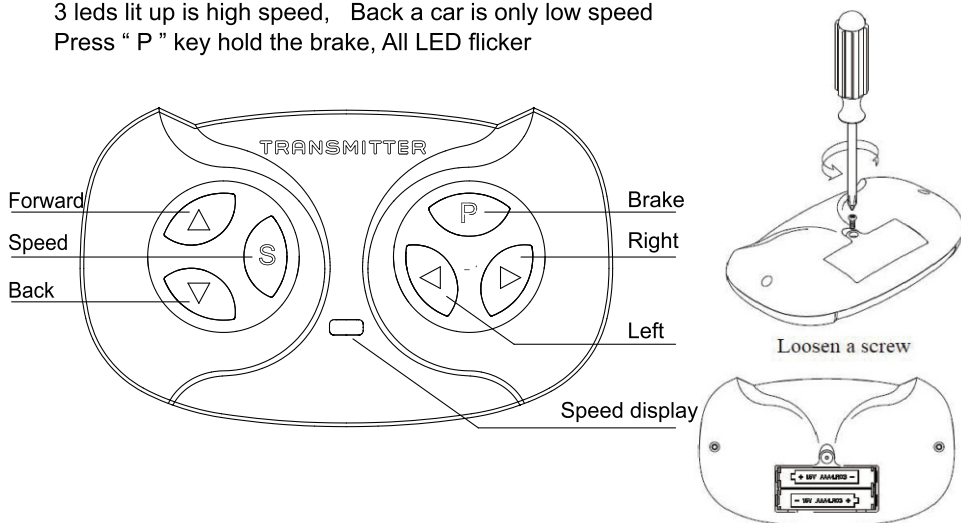

WARNING:

The remote control is not a toy. It is for the adult use only, and should not be used by a child. A close adult supervision is always required. Reception range may change significantly with weather, battery, and other environmental conditions.

When the remote control is operated, the pedal switch of the product is invalid; when the remote control is cut off, the pedal switch can be used.

Charging Your Vehicle

ONLY AN ADULT CAN CHARGE AND RECHARGE THE BATTERY!

WARNING!

- **PREVENT FIRE AND ELECTRIC SHOCK:**

- Use the only rechargeable battery and charger supplied with your vehicle. NEVER substitute the battery or the charger with another brand. Using another battery or charger may cause a fire or explosion.
- Do not use the battery or charger for any other product. Overheating, fire or explosion could occur.
- NEVER modify the electric circuit system. Tampering with the electric system may cause a shock, fire or explosion or may permanently damage the system.
- Do not allow direct contact between battery terminals. Fire or explosion can occur.
- Do not allow any type of liquid on the battery or its components.
- Explosive gasses are created during charging. Do not charge near heat or flammable materials. Charge the battery in a well-ventilated area ONLY.
- NEVER pick up the battery by the wires or charger. Damage can occur to the battery and may cause a fire. Pick up the battery by the case ONLY.
- Charge the battery in a dry area ONLY.
- Remove high-lighted section. **Wash hands after handling.**
- Do not open the battery. Battery contains lead acid and other materials that are toxic and corrosive.

Troubleshooting Guide

■ **PROBLEM: The vehicle does not run**

PROBLEM CAUSE: The battery may low on power.

After each use, or once a month minimum, charge the battery for 8-12 hours. Do not leave the battery on the charger for more than 20 hours.

POSSIBLE CAUSE: Thermal fuse has tripped.

The vehicle is equipped with a self-resetting fuse. When the vehicle is overloaded or operated incorrectly; the self-resetting fuse will be cut off for 5-20 seconds before becoming operational again. The self-resetting fuse is under the seat (Refer to the picture.)

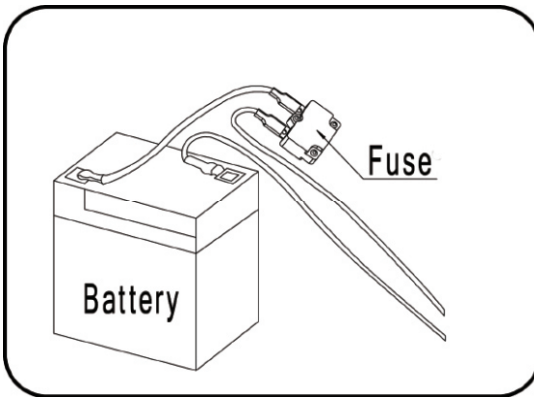

To avoid the fuse cut off the power, follow these guidelines:

DO NOT overload the vehicle, Maximum weight

The maximum weight see in the specification

DO NOT tow anything behind the vehicle.

DO NOT drive up steep slopes.

DO NOT drive into fixed objects, which may cause the wheels to spin, causing the motor to overheat.

DO NOT drive in very hot weather, components may overheat.

DO NOT tamper with the electric system, Doing so may create a short circuit, causing the fuse to trip.

POSSIBLE CAUSE: Wheel nuts are loose.

If the nuts are not tight, the wheels will not engage the forward gears. Tighten the nut with the nut wrench.

POSSIBLE CAUSE: Battery connector or wires are loose.

Make Sure the battery connectors are firmly plugged in to each other.

POSSIBLE CAUSE: Battery is dead.

Have you properly maintained the battery according to the directions? Is the battery old? Your battery may need to be replaced.

POSSIBLE CAUSE: Electric system is damaged.

Water may have corroded the system, or loose dirt, gravel or sand might have jammed the switch.

POSSIBLE CAUSE: Motor is damaged.

The motor needs professional repair.

■ **PROBLEM: The battery will not recharge.**

POSSIBLE CAUSE: Battery connector or adapter connector is loose.

Make sure the battery connector and adapter connector are firmly plugged together.

POSSIBLE CAUSE: Charger is not plugged in.

Make sure the charger is plugged into the wall outlet and the power flow to the outlet is on.

POSSIBLE CAUSE: Charger is not working.

Is the charger warm while charging? If not, the charger may be broken and may need to be replaced.

Troubleshooting Guide

■ **PROBLEM: The vehicle does not run very long.**

POSSIBLE CAUSE: Battery may be undercharged.

You may not be charging the battery long enough. After each use, or once a month minimum, charge the battery for 8 to 12 hours. Do not leave the battery on the charger for more than 20 hours.

POSSIBLE CAUSE: Battery is old.

The battery will eventually lose the ability to hold a charge. Depending on the amount of use, and varying conditions, the battery should operate for one to three years. Replace the battery with a new One.

■ **PROBLEM: Battery buzzes or gurgles when charging.**

This is normal and not a cause for concern. It may also be silent when charging, which is also normal.

■ **PROBLEM: Charger feels warm when recharging battery.**

This is normal and not a cause for concern.

Maintaining Your Vehicle

- It is parents' responsibility to check main parts of the toy before using. Must regularly examine for potential hazard, such as the battery, charge, cable or cord, plug, screws are fastening enclosure of other parts and that in the event of such damage, the toy must not be until that damage had been properly removed.
- Make sure the plastic parts of the vehicle are not cracked or broken.
- Occasionally use a lightweight oil to lubricate moving parts such as wheels.
- Park the vehicle indoors or cover it with a tarp to protect it from wet weather.
- Keep the vehicle away from sources of heat, such as stoves and heaters. Plastic parts may melt.
- Recharge the battery after each use. Only an adult can handle the battery. Recharge the battery at least once a month when the vehicle Raider is not being used.
- Do not wash the vehicle with a hose. Do not wash the vehicle with soap and water. Do not drive the vehicle in rainy or snowy weather. Water will damage the motor, electric system and battery.
- Clean the vehicle with a soft, dry cloth. To restore shine to plastic parts, use a non-wax furniture polish. Do not use car wax. Do not use abrasive cleaners.
- Do not drive the vehicle in loose dirt, sand or fine gravel which could damage moving parts, motors or the electric system.
- When not using, all the electrical source should be turned off. Turn off the power switch and disconnect the battery connection.

Disposal Of Battery

Disposal Of Battery



- Your sealed lead-acid battery must be recycled or disposed of in an environmentally sound manner.
- Do not dispose of your lead-acid battery in a fire. The battery may explode or leak.
- Do not dispose of a lead-acid battery in your regular, household trash. The incineration, land filling or mixing of sealed lead-acid batteries with household trash is prohibited by law.
- Return an exhausted battery to your local approved lead-acid battery recycle, such as a local seller of automotive batteries.
- Contact your local waste management officials for other information regarding the environmentally sound recycling and disposal of lead-acid batteries.
- The battery must be charged only by adult .Please charge the product before using!
- The toy should not be connected to excessive powers (more than the quantity specified herein), and it should not be operated during charging process.
- Any rechargeable battery must only be charged under adult's supervision.
- Battery charger shall regularly check the wires, plugs. casing and other parts for damage and found damage should stop using and restored.
- Open the battery cover on the remote control, and put two pieces of batteries,paying attention to batteries polarity. Replace the battery cover and lock with screws (please replace the battery according to the above steps and should be done by adult) .
- All batteries should be inserted with the correct polarity.
- Non-rechargeable battery should not be charged, please remove any running-off battery from the toy.
- Do not use old and new batteries together, or mix different types of batteries.
- The battery charger used with the toy are to be regularly examined for damage to the cord, plug, enclosure and other parts, and in the event of such damage, they must not be used until that damage had been repaired.

EXECUTION STANDARD:EN71 EN62115 ASTM F963 CPSIA